

Instructions For Use

Protective Access Containers

1

Assemble the lid with 4 clicks

Ensure the label and fill line faces the front.

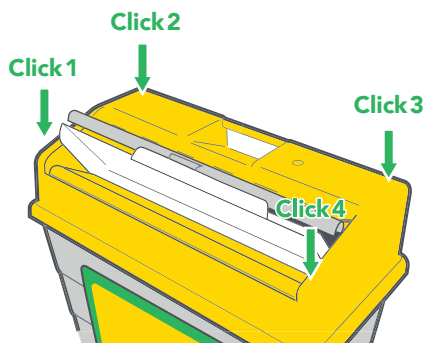

2

Never fill above the line

Always replace your sharps container when full to avoid needle stick injuries.

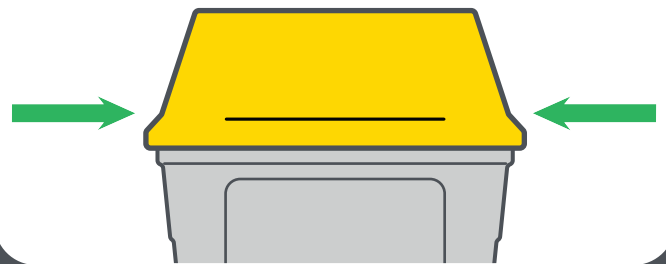

3

Place sharps waste in the aperture

Object will rest on the Protective Access lid.



4

Press down on the Protective Access Lid

The sharps will drop into the container while the lid is temporarily closed.

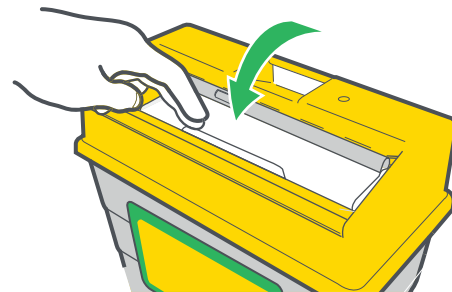

5

Release the Protective Access lid

Allow the lid to return back to its original position. Ensure the sharps has dropped and aperture is clear.

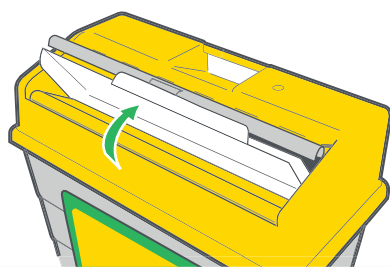

6

Final closure

Engage final closure when container is ready for disposal. Place the container on a suitable surface, pull and rotate the flap over the aperture then firmly apply pressure along the front of the flap.

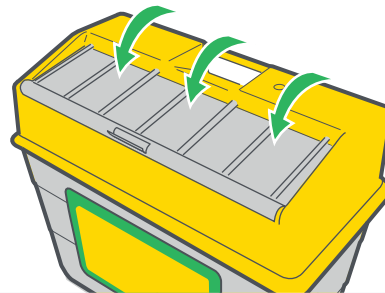

FOR MORE INFORMATION:

✉ sales@plascare.com.au

🌐 sharpsafe.com.au 📞 +61 (03) 9458 5118